



IDEASWOOD  
SIMPLE LIVING MADE EASY

## Garage 3.2m x 5.2m with 44mm walls

Garage 3.2 m x 5.2m with 44mm walls.

- ☑ Hinged barn style doors to front
- ☑ Half glass access door to side
- ☑ 1 window

Kits come complete in waterproof breathable film.

All interlocking solid timber wall boards, windows, doors and ceiling boards. Detailed plans and a clear parts list as well as all nails, screw etc to complete the building structure are included.

Roof and Sub Floor systems are available to suit your site and preferences.

**Please contact our team to discuss your project and onsite construction if required.**



# Garage 3.2m x 5.2m with 44mm walls

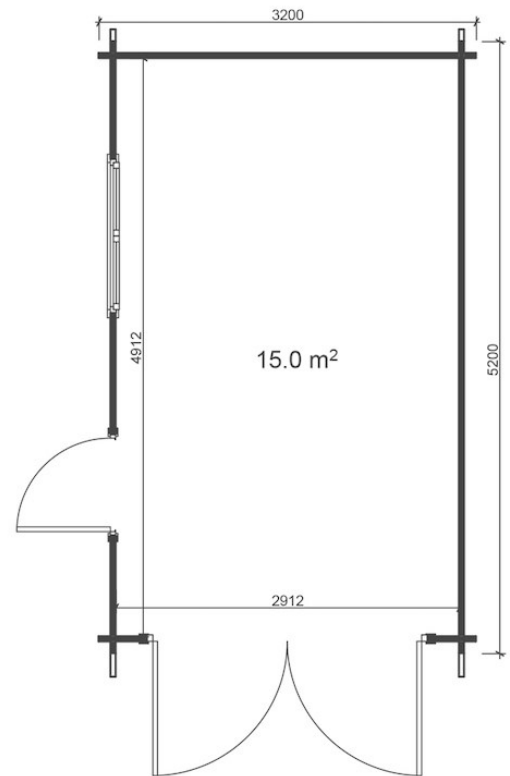

## Specifications

External Measures	3.2x5.2m
Internal Area	14.3m <sup>2</sup>
Roof Area	20.3m <sup>2</sup>
Underlayer	23m <sup>2</sup>
External Wall Area for Insulation	36.3m <sup>2</sup>
External Wall Area for Painting	36.3m <sup>2</sup>
Base Footprint	3x5m
Door Type	Single half glass
Door Measures	1.98x0.85m (Premium) 1.85x0.85m (Economy)
Threshold	Covered with steel
Window Type	1 double
Window Measures	0.92x1.3m
Floor Boards	19mm
Roof Overhang	0.2m
Roof Angle	18°
Wall Height	2.23m
Total Height	2.7m
Possible Reverse Montage	Yes