

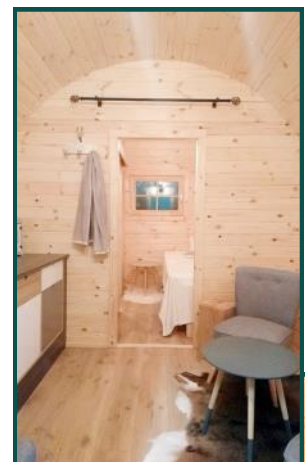

IDEASWOOD  
SIMPLE LIVING MADE EASY

## Camping Pod 3m x 5.9m with 28mm walls

- ☑ Standard pod includes roof covered with bitumen shingles (in choice of colours)
- ☑ 28mm Nordic Spruce floorboards
- ☑ 1 double glazed opening window on the back wall
- ☑ French Style glazed door with standard handle and lock
- ☑ Small inside room with door for bathroom
- ☑ Inside wall and door included.
- ☑ 2 rooms
- ☑ Suitable for 2-4 people
  - ☑ Optional extras include terrace made from 28mm decking boards



# Camping Pod 3m x 5.9m with 28mm walls

3.00x6.00 (28 mm)

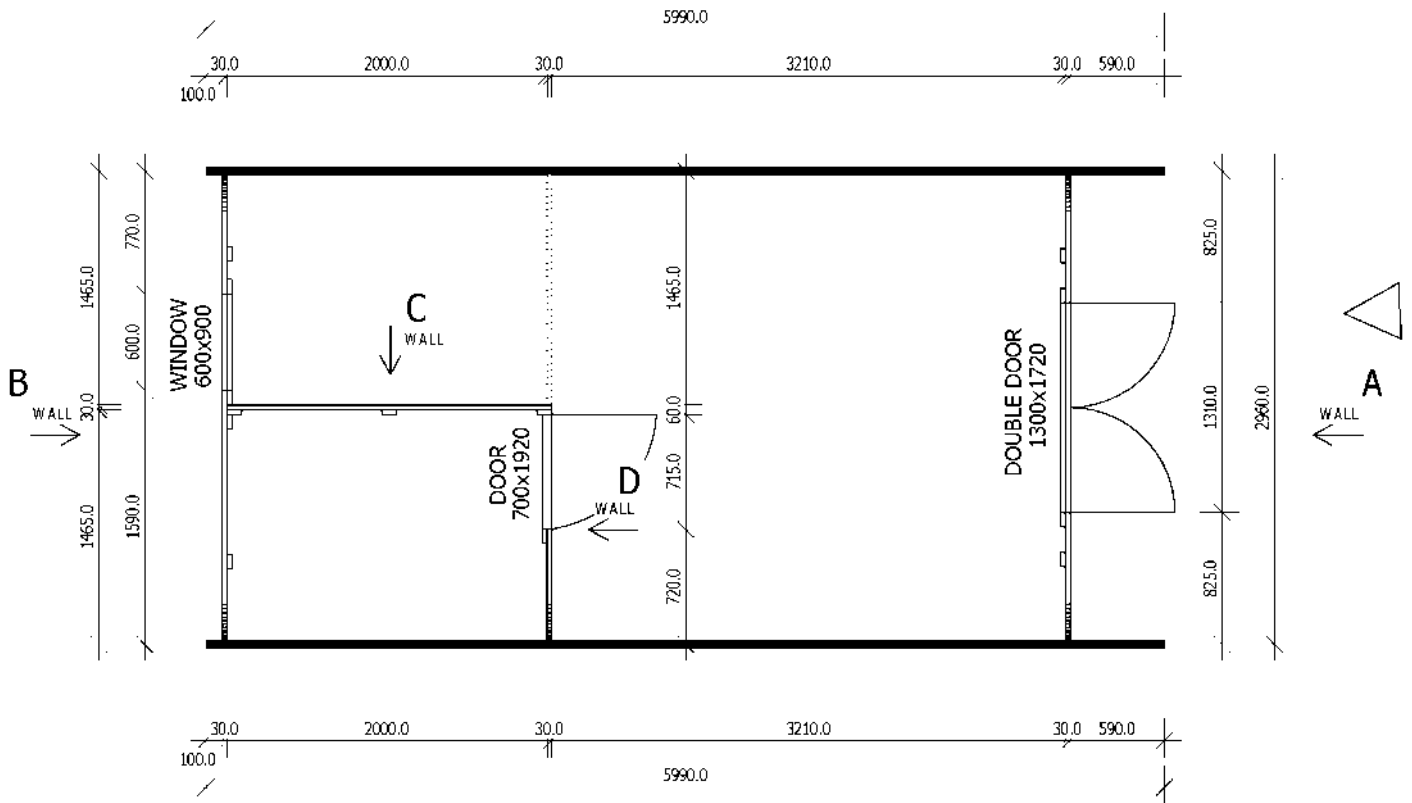

 <b>Specifications</b> Camping Pod 3m x 5.9m (with 28mm walls)	
Description	Measurements
External Measures (m)	3 x 5.9
Internal Area (m <sup>2</sup> )	15.0
Height (m)	2.6
Floor Thickness (mm)	20
Roof finishing	Bitumen Shingles
Window Type	1 single
Window Measures (mm)	600 x 900
Door Measures (mm)	1280 x 1800 x 700x 1920
Terrace (mm)	1200



Bitumen Roof Tile Sample Colours