

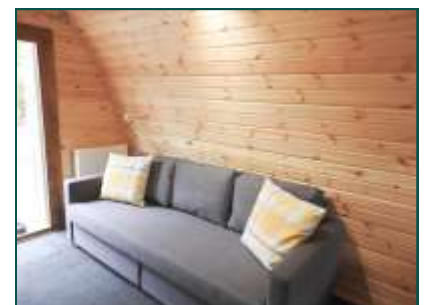

IDEASWOOD  
SIMPLE LIVING MADE EASY

## Camping Pod 3m x 5.9m with 44mm walls

- ✓ Standard pod includes roof covered with bitumen shingles (in choice of colours)
- ✓ 28mm Nordic Spruce floorboards
- ✓ 1 double glazed opening window on the back wall
- ✓ French Style glazed door with standard handle and lock
- ✓ Small inside room with door for bathroom
- ✓ Inside wall and door included.
- ✓ 2 rooms
- ✓ Suitable for 2-4 people
- ✓ Optional extras include terrace made from 28mm decking boards



# Camping Pod 3m x 5.9m with 44mm walls

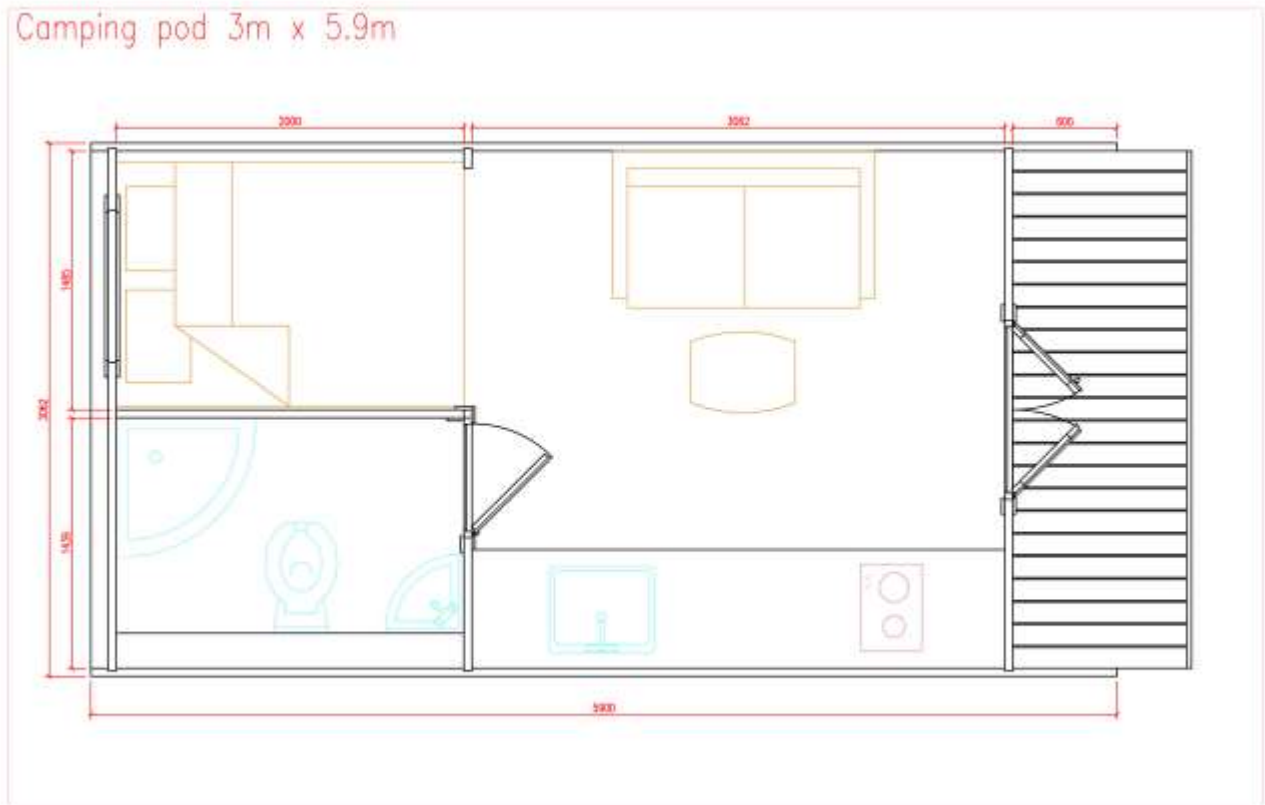

 <b>Specifications</b> Camping Pod 3m x 5.9m (with 44mm walls)	
Description	Measurements (m)
External Measures (m)	3 x 5.9
Internal Area (m <sup>2</sup> )	15.03
Height (m)	2.7
Floor Thickness (mm)	28mm
Roof finishing	Bitumen Shingles
Window Type	1 single
Window Measures (mm)	700 x 900
Door Measures (mm)	1030 x 1900
Terrace (mm)	Can be customised



Bitumen Roof Tile Sample Colours